

## REDUCED TEE 90°

03 Update - 06/2023

### TECHNICAL DATA

Article No	001 117 0042 0200
d1 (mm)	315
d2 (mm)	200
L (mm)	712
le1 (mm)	156
le2 (mm)	117
Z (mm)	317
s1 (mm)	28,6
s2 (mm)	18,2
Weight (Kg)	23,050
Box Quantity (pcs)	1
Box Dimension (pcs)	53,5x73,5x34,5

### IDENTIFICATION OF PRODUCT

D(mm)	315-200
SDR	11
RAW METARIAL	PE 100
PRESSURE CLASS	16 Bar Water 10 Bar Gas
TRADEMARK	NTG
EXECUTION	Injection Moulded
STANDARD	EN 12201-3 EN 1555-3 AS /NZS 4129

### INJECTION MOULDED

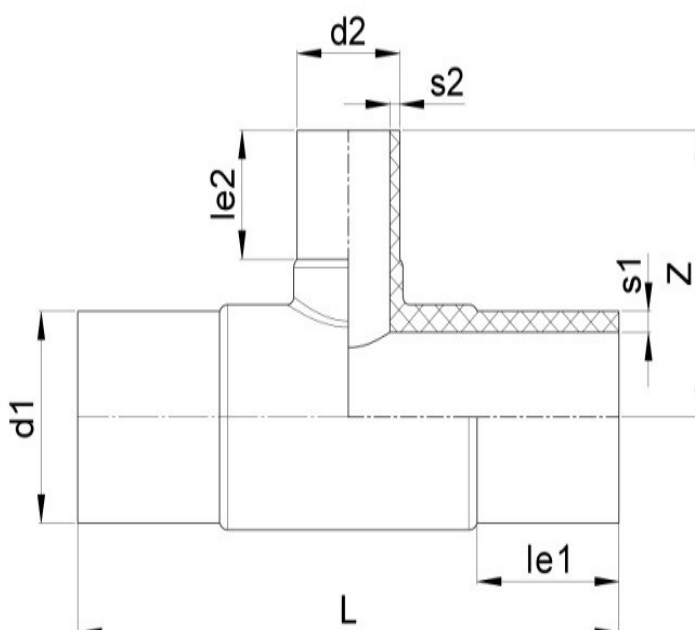

### SPECIFICATION

Long Spigot

Tolerance on diameters and thickness according to the standards. The other dimensions are specialized. Tolerance  $\pm 5\%$ . NTG PLASTIK reserves all the right to change any information without giving prior notice. The production, distribution and utilization of this document without explicit authorization is prohibited.